

Goldhurst Terrace, South Hampstead, London



- Available 4th June. 1 bed flat on the 1st floor of this period building at the top part of Goldhurst Terrace
- Superb reception with open plan fitted kitchen.
- Part Furnished. EPC:D. Council Tax D.
- Close to Finchley Road underground and Finchley & Frognal overground stations.
- Double bedroom, bathroom with window
- Viewing via Rose & Co Estates 020 7372 8488



Weekly Rental £ 415 Monthly £1800

Approximate Gross Internal Area = 519 sq ft / 48.2 sq m

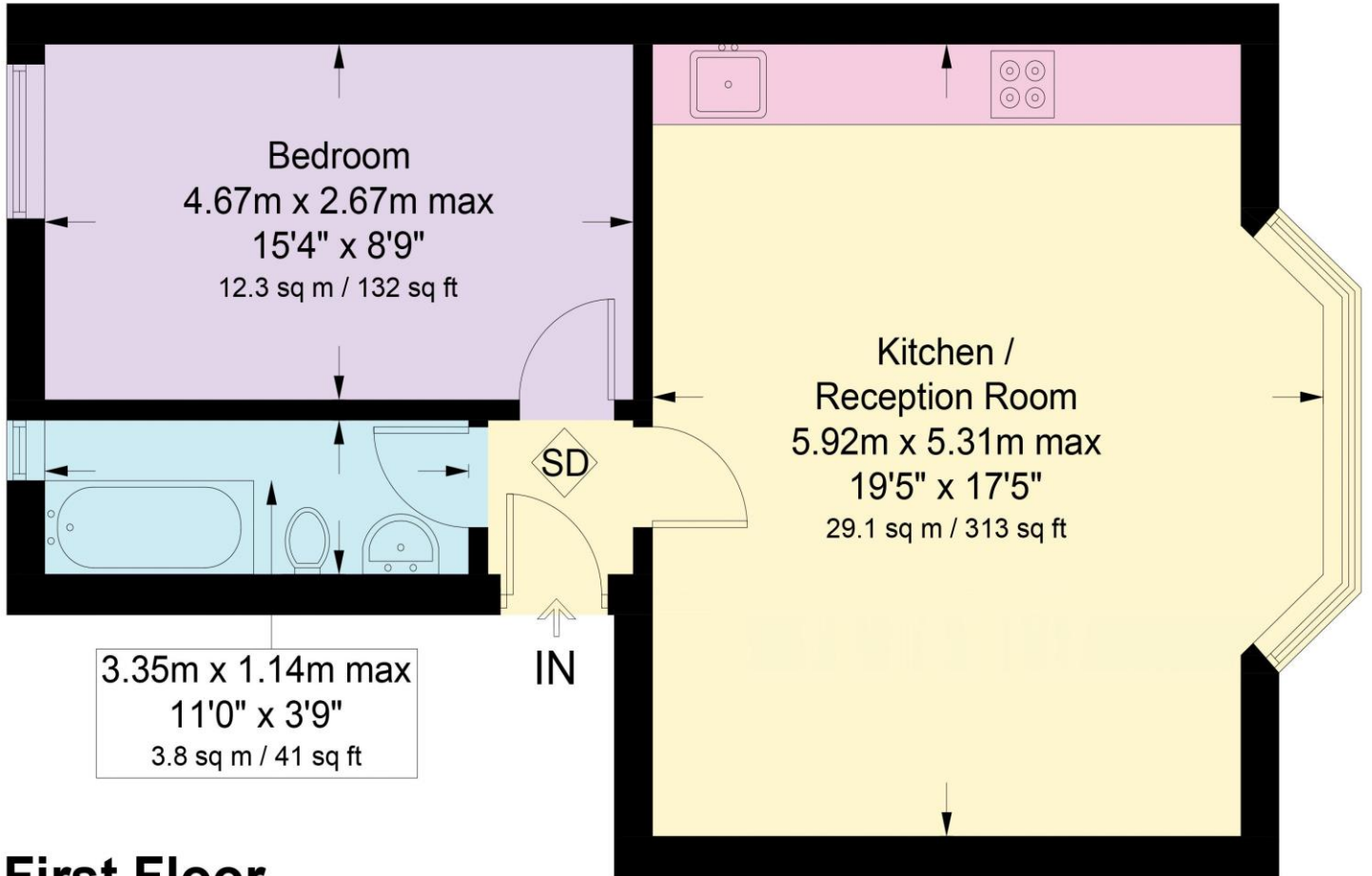

First Floor

Illustration for identification purposes only, measurements are approximate, not to scale. floorplansUsketch.com © (ID967305)

Energy performance certificate (EPC)

Flat 2 3 Goldhurst Terrace LONDON NW6 3HX	Energy rating C	Valid until: 20 September 2033 <hr/> Certificate number: 2296-3030-2201-2227-4200
--	---------------------------	--

Property type

Mid-floor flat

Total floor area

48 square metres

Rules on letting this property

Properties can be let if they have an energy rating from A to E.

You can read [guidance for landlords on the regulations and exemptions \(https://www.gov.uk/guidance/domestic-private-rented-property-minimum-energy-efficiency-standard-landlord-guidance\)](https://www.gov.uk/guidance/domestic-private-rented-property-minimum-energy-efficiency-standard-landlord-guidance).

Energy rating and score

This property's current energy rating is C. It has the potential to be B.

[See how to improve this property's energy efficiency.](#)

Score	Energy rating	Current	Potential
92+	A		
81-91	B		82 B
69-80	C	78 C	
55-68	D		
39-54	E		
21-38	F		
1-20	G		

The graph shows this property's current and potential energy rating.

Properties get a rating from A (best) to G (worst) and a score. The better the rating and score, the lower your energy bills are likely to be.

For properties in England and Wales:

- the average energy rating is D
- the average energy score is 60

Breakdown of property's energy performance

Features in this property

Features get a rating from very good to very poor, based on how energy efficient they are. Ratings are not based on how well features work or their condition.

Assumed ratings are based on the property's age and type. They are used for features the assessor could not inspect.

Feature	Description	Rating
Wall	Solid brick, as built, no insulation (assumed)	Poor